



# Keyed Cylinder

## Cleaning Instructions

**HEALTH AND SAFETY AT WORK ACT 1974**

Users are reminded of their obligation to ensure that all persons involved in handling, installing, disposing of this product are made aware of these notes and that sufficient information is passed to your customer to comply with the Act. In particular, note that under no circumstances should the vehicle in which the shutter is fitted be driven or be in motion at all when the shutter is in the open position.

As part of the important Maintenance Information provided with every roller shutter door.  
We would like to remind you



## WARNING

HEALTH AND SAFETY AT WORK ACT 1974  
Users of the JR Industries Ltd doors are reminded of their obligation to ensure that all persons involved in handling, using, maintaining or disposing of this product, are made aware of these instructions.



**ALWAYS CLOSE AND LOCK THE DOOR BEFORE DRIVING VEHICLE**

**DO NOT MOVE VEHICLE WITH DOOR IN THE UNDER ROOF POSITION**

### IMPORTANT MAINTENANCE INFORMATION

**The following should be read and included in the Maintenance Schedule**

This door is constructed of high quality components intended to provide years of continued service. When in operation it is a large moving object, therefore, to ensure safe, reliable and continued operation, the following cautionary directions and periodic maintenance instructions must be observed.

1. While door is moving do not stand within opening or walk through doorway.
2. Operate door only when correctly adjusted and free from obstructions.
3. High-Pressure cleaners or solvents can damage the door.
4. If door becomes difficult to operate or completely inoperative, it must be repaired immediately by an approved agent. Particular care should be given to the counter balance and cables. Repair and adjustment can be **hazardous** and should only be performed by an **approved agent**.
5. **Daily**:- A general visual inspection of the shutter should be carried out, with specific attention to the cable along the full length.
6. Replace any frayed or otherwise damaged cables.
7. Ensure regular checks and maintenance on items shown below (**Every 6-8 weeks**)
  - All nuts, bolts, screws and rivets to be checked for tightness.
  - Check **all** rollers operate smoothly, and slide freely in holder (replace worn, damaged or seized rollers). *It would be good practice to replace all rollers when they are judged to be worn - this will prevent regularly having to change rollers and the possibility of a damaged roller causing damage to the tracks and/or shutter.*
  - Check side seals for damage (replace if required).
  - Replace frayed or worn pull straps. DO NOT attach anything to the pull strap.
  - Where a lock mechanism is fitted & controlled by a keyed cylinder lubricate the cylinder **ONLY** (using manufacturer's recommended lubricant).
  - Other parts of the lock mechanism can be lubricated with light oil.
  - Tracks must be **clear** of grease and dirt.
  - Check shutter operation, lubricate roller shafts, bearings, hinges, tracks and balancer spring with light oil (**not grease**) the use of aerosol dispersal/cleaning products (CRC/WD40) are not recommended as this may wash away the grease packed in the roller bearings.
  - Check door panels (inside and out) for gouges or paint chips, and repaint as needed.
  - If you repaint, check and if necessary re-adjust tension on lifting mechanism to restore ease of operation.

**NOTE: A recommended lubricant WURTH HHS 2000.**

Use only genuine JR Industries spare parts; the use of any other manufactured parts or not following the above will invalidate the warranty. In the unlikely event of an operational or warranty concern please contact:

Customer Services +44 (0) 29 2085 7675  
Mobile 07816 161487

JR Industries has a network of Agents, for your nearest Agent please contact:  
JR Industries Ltd. Whiting House, Sir Alfred Owen Way, Pontygwindy Industrial Estate, Caerphilly CF83 3HU  
Tel: +44 (0)29 2085 7630 or visit [www.jrindustries.co.uk](http://www.jrindustries.co.uk)

## 2

### Cleaning Cylinder

JR Industries recommend the regular use of Dormakaba Cleaner for the maintenance of keyed cylinders. Unlike other products on the market, the Dormakaba Cleaner does not thicken, eliminating the need to constantly re-lubricate the lock cylinder

#### DO NOT USE GREASE TO LUBRICATE THE CYLINDER

Dormakaba cleaner is available from **J R Industries Ltd**  
Supplied in 200ml spray cans (Part Number **30110-1050-00**) .  
Tel: 0292085 7630 | sales@jrindustries.co.uk



#### Advantages at a glance

- ...High level of corrosion protection
- ...Outstanding cleaning and lubrication properties
- ...Extremely economical dosing

- ...Suitable for use at temperatures as low as -25°C
- ...Free of heavy metals
- ...Silicone free
- ...Exceptional long-lasting effect

#### Instructions for use

1) Shake the cleaner well



2) Screw the small red tube on to the valve.

*(be sure not to just insert it, as otherwise the tube could buckle)*

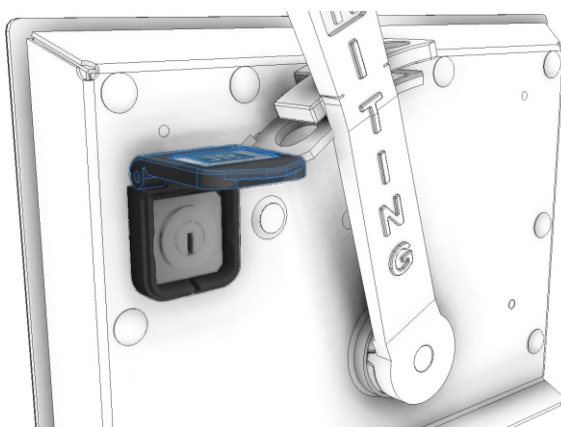

3) Lift Dust cap (if fitted)

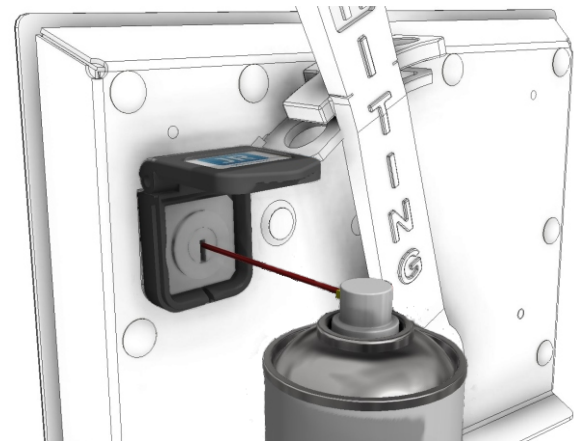

4) Hold the tube in the keyhole and operate pump

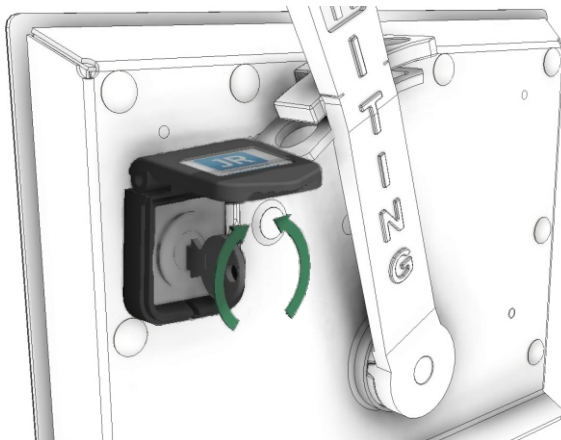

5) Remove tube..

Insert Key & turn it several times in either direction to ensure an even coating of lubricant inside the cylinder.



6) Remove Key & wipe clean on a soft cloth until no residue remains